

82 Worman's Mill Ct
Suite G
Frederick, MD 21701
Phone: 301-695-0880
Fax: 301-293-6009

TOWN OF TOWN OF EMMITSBURG, MD DePaul Street Waterline Pre-Bid Agenda

ADDENDUM NO. 6

This Addendum shall be incorporated into and form a part of the Contract Documents it shall modify the original Bidding Documents dated January 5, 2024, as noted below. All bids shall be based on this Addendum, in accordance with the bidding documents. Bidder must acknowledge receipt of this Addendum in the space provided on the Bid Form. Failure to do so may subject Bidder to disqualification.

This Addendum consists of THREE (3) pages.

1. Is there a preferred method for connecting the temp waterline to the existing 6" waterline on plan sheet 7, near the bridge on MD Route 140? For example, tapping sleeve and valve.
 - No preferred method. It is up to each contractor.
2. Sheet 3 of 12, at the intersection of Depaul st and N Seton ave, there is a note that is cut off- it says...ex 6" water @ main. Is this the cut and cap location?
 - Sheet 3 has been revised. It is attached tot his addendum.
3. At the intersection of N Seton and Depaul st, there is a hydrant on the 4" water main. Would you want that moved onto the new 8" water main that is being installed? Also can the hydrant be used as a feed for the bypass, if the intersection is isolated as a first priority?
 - The fire hydrant on N. Seton should stay in place.
 - This hydrant can be used for the bypass.

4. Regarding the wage rate from 2010 by the same gentlemen prior.
(To be accurate, you had said this was answered in the addendum #4 per USDA)

- For further clarification...

The 2010 citation refers to a teamster/union declaration that is still informing those ABC fringe benefit additions.

This section refers to truck drivers who are on the site MORE than de minimis-- meaning they're there for a *significant* amount of time *beyond just to load items on-and-off*.

If this is the case, the contractor is to include the fringe per hour earned that workweek, plus A. Being paid for holidays that workweek, B. plus C. paid vacation.

- Also please note the following:

Contractors should consider they can pay at least the required minimum wage and fringe, when they are preparing their bid responses.

Paid holiday leave for eligible classifications (e.g. Operators) that list "+a" for paid holidays are as follows:

1. New Year's Day - January 1, 2024 (Sunday)
2. Memorial Day - May 27, 2024 (Monday)
3. Independence Day - July 4, 2024 (Thursday)
4. Labor Day - September 2, 2024 (Monday)
5. Thanksgiving Day - November 28, 2024 (Thursday)
6. Day After Thanksgiving - November 29, 2024 (Friday)
7. Christmas Day - December 25, 2024 (Wednesday)

5. Is an attachment, requesting to confirm that the attached contains all the forms required for the bid submission.

- The list of bid documents required is included with Addendum #5.

6. Per addendum #5, would the town consider using 3" ductile iron pipe instead of 3" copper for the service at 511?

- 3" ductile iron may be used but it must be able to connect to the existing shut-off and water service.

7. For the debarment check, do we do that ourselves or how do we fill out this form?

- Bidders only need to fill out the required information.

END OF ADDENDUM NO.6

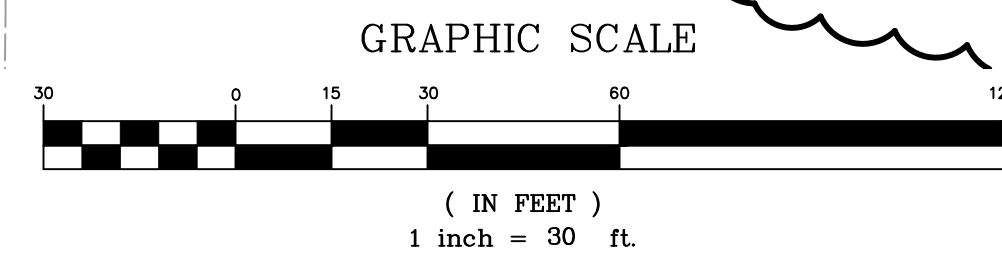
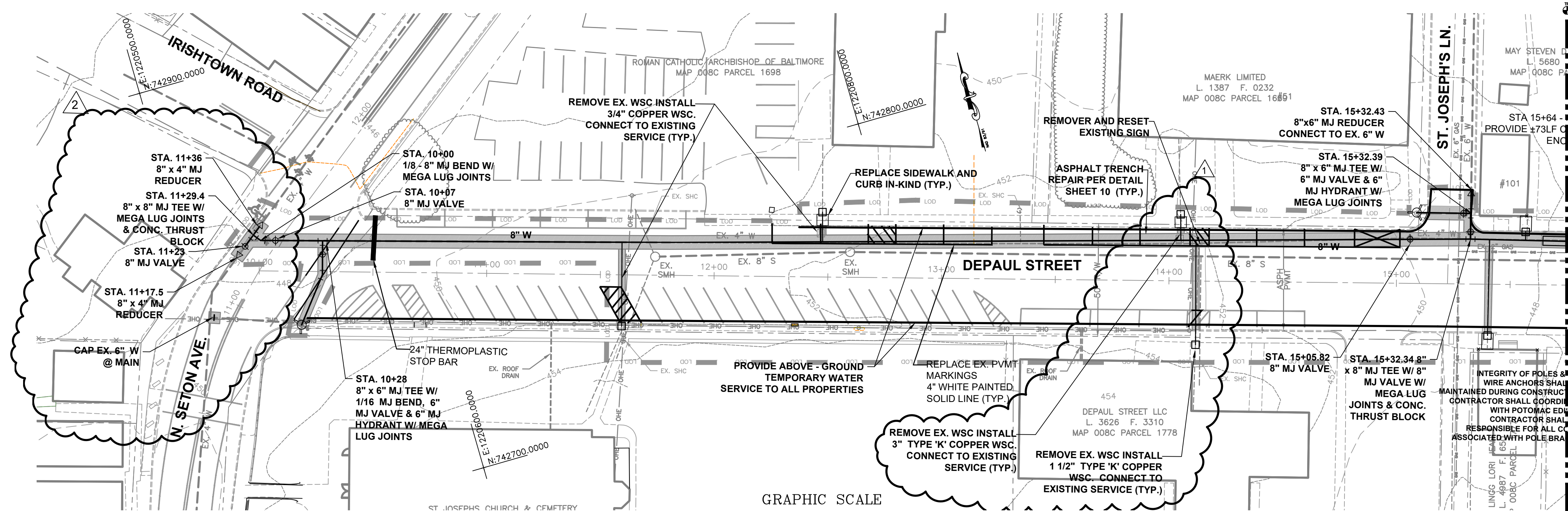

PROFILE
SCALE: HORIZ. - 1" = 30'
VERT. - 1" = 3'

- NOTES:
- CONTRACTOR MUST TEST PIT EXISTING UTILITIES TO VERIFY EXACT HORIZONTAL AND VERTICAL LOCATION. THE CONTRACTOR SHALL NOTIFY THE ENGINEER AND INSPECTOR OF ANY DISCREPANCIES.
 - EXCAVATED MATERIAL SHALL BE PLACED ON THE HIGH SIDE OF THE TRENCH. ALL TRENCHES SHALL BE BACK-FILLED AND STABILIZATION ON ALL DISTURBED AREAS SHALL OCCUR AT THE END OF EACH WEEK, EXCEPT FOR THE PORTION NECESSARY TO RESUME CONSTRUCTION. ANY DISTURBED AREAS OR STOCKPILES NOT STABILIZED AT THE END OF EACH DAY SHALL BE PROTECTED AND HAVE SEDIMENT CONTROLLED BY THE USE OF STRAW BALE DIKES, EARTH BERMS AND SILT FENCES AS DIRECTED BY THE SEDIMENT CONTROL INSPECTOR.
 - ROADWAY EMBANKMENT STRUCTURAL FILL SHALL BE COMPACTED TO 95% MAXIMUM DRY DENSITY PER ASSHTO T-180 METHOD "C". UTILITY TRENCH STRUCTURAL FILL SHALL BE COMPACTED TO 95% MAXIMUM DRY DENSITY ASSHTO T-99 METHOD "A" OR AS MODIFIED BY THE GEOTECHNICAL ENGINEER.
 - ALL EXISTING WATERMAIN THAT IS BEING REPLACED BY THIS CONTRACT SHALL BE REMOVED AND DISPOSED OF BY THE CONTRACTOR.
 - ALL WATERMAIN SHALL HAVE 3'-6" MINIMUM COVER BELOW EXISTING GROUND.
 - THE CONTRACTOR SHALL COORDINATE SHUT DOWN WITH TOWN OF EMMITSBURG PERSONNEL.
 - CONTRACTOR IS RESPONSIBLE TO MAINTAIN THE INTEGRITY OF POLES & GUY WIRE ANCHORS DURING CONSTRUCTION. CONTRACTOR SHALL COORDINATE WITH FIRST ENERGY TO DETERMINE THE NEED FOR POLE BRACING.

TEMPORARY WATER SERVICE

THE CONTRACTOR SHALL PROVIDE A TEMPORARY WATER SERVICE LINE FOR THIS PROJECT. THE TEMPORARY SERVICE LINE MUST BE PLACED IN A MANNER THAT ALLOWS INGRESS/EGRESS TO PRIVATE PROPERTY AND PUBLIC STREET ALLEYS. THE CONTRACTOR SHALL PREPARE A DETAILED TEMPORARY SERVICE PLAN AND SUBMIT IT FOR TOWN APPROVAL PRIOR TO STARTING CONSTRUCTION. THE SEQUENCE OF CONSTRUCTION SHALL BE DETERMINED BY THE ENGINEER.

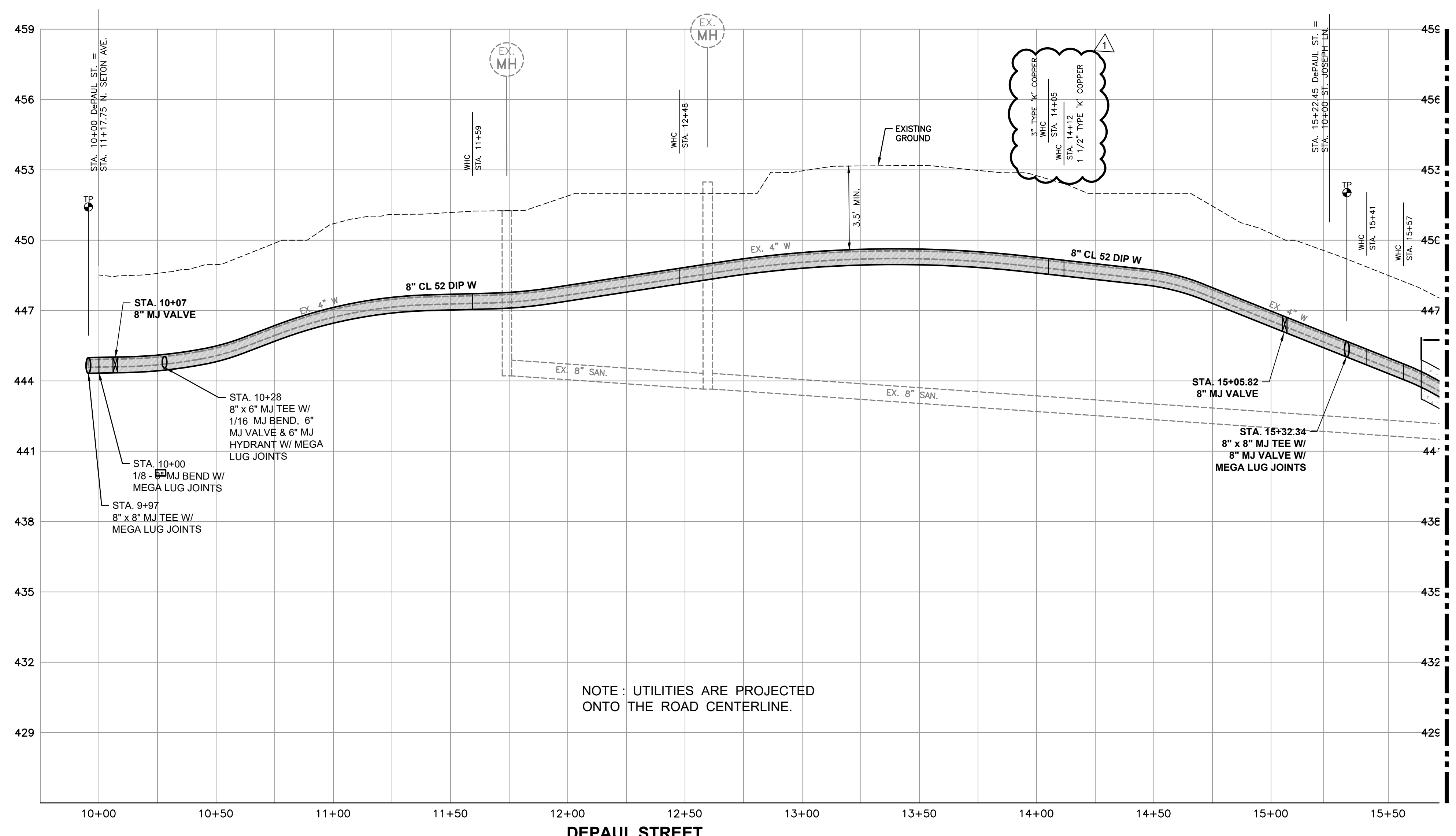

NOTE: UTILITIES ARE PROJECTED ONTO THE ROAD CENTERLINE.

MATCH LINE - SEE SHEET 4 OF 12



FOX & ASSOCIATES, INC.
ENGINEERS-SURVEYORS-PLANNERS
82 MORRIS MILL COURT
SUITE 'G'
FREDERICK, MD. 21701
PHONE: (301)733-6600
FAX: (301)733-6009
WWW.FOXASOCIATESINC.COM Email: FOX@FOXASOCIATESINC.COM

DRAWN BY: _____
REVISION: _____
DATE: 02/05/24
REVISED WATER SERVICE SIZES: 01/31/24

WATER MAIN PLAN AND PROFILE
TOWN OF EMMITSBURG
DEPAUL ST WATER MAIN REPLACEMENT
PHASE 1
SITUATED ALONG DEPAUL STREET
TOWN OF EMMITSBURG
FREDERICK COUNTY, MARYLAND

BID SET 12/22/2023

APPROVED BY:
TOWN OF EMMITSBURG

TOWN MAYOR _____ DATE _____
TOWN PLANNING DEPARTMENT _____ DATE _____



I HEREBY CERTIFY THAT THESE DOCUMENTS WERE PREPARED OR APPROVED BY ME, AND THAT I AM A DULY LICENSED PROFESSIONAL ENGINEER UNDER THE LAWS OF THE STATE OF MARYLAND.

PROJECT NO. 23-31965
DRAWING NO. D-3609
DATE: DECEMBER 2023
DRAWN BY: JHC
CHECKED BY: JHC

FREDERICK SOIL CONSERVATION DISTRICT
SOIL EROSION AND SEDIMENT CONTROL PLAN APPROVAL

By: _____ DISTRICT MANAGER OR DESIGNEE
Date: _____ PLAN IS VALID FOR TWO YEARS FROM DATE OF APPROVAL.

SOD APPROVAL FOR SEDIMENT AND EROSION CONTROL IS IN ACCORDANCE WITH THE 2011 MARYLAND STANDARDS AND SPECIFICATIONS FOR SOIL EROSION AND SEDIMENT CONTROL AND IS CONTINGENT UPON ISSUANCE OF ALL APPLICABLE REGULATORY PERMITS.